

STONEBRIDGE VILLAGE

CITY OF PORT COLBORNE



WINDSOR TERRACE

WEST SIDE ROAD (HWY NO. 58)

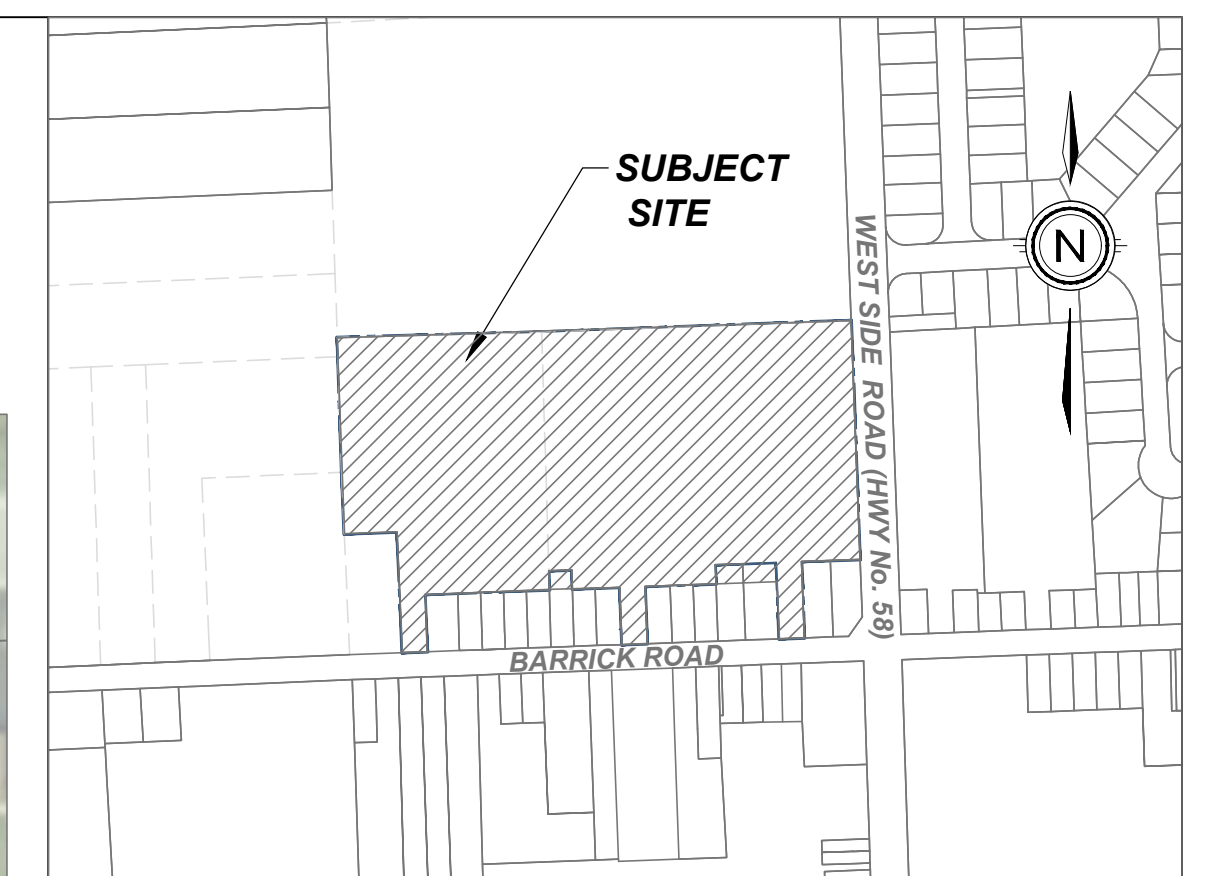

KEY PLAN

COLOUR DEMONSTRATION OF SUBDIVISION

LEGAL DESCRIPTION

PART OF LOT 31,
CONCESSION 3
GEOGRAPHIC TOWNSHIP OF
HUMBERSTONE
CITY OF PORT COLBORNE
REGIONAL MUNICIPALITY OF NIAGARA

#	ISSUED FOR	DATE	INIT
0	ISSUED FOR	YYYY-MM-DD	
	REVISION	DATE	INIT



DRAWING TITLE	DRAFTING	AM
COLOUR DEMONSTRATION OF SUBDIVISION	DATE	MARCH 25, 2024
	PRINTED	MAY 3, 2024
	SCALE	1:750
DWG. No.	2300-CD	REV
		0