



## Media Release

### For Immediate Release

## Headed to Canal Days concerts?

*Everything you need to know about your trip to H.H. Knoll Lakeview Park*

**Port Colborne, ON (August 1, 2019)** – From August 2-5, 2019 the Canal Days Concert Series, as part of the 41<sup>st</sup> Annual Canal Days Marine Heritage Festival, presented by Vale and Rankin Construction Inc. brings top-notch entertainment to H.H. Knoll Lakeview Park. Here is everything a visitor, or resident, needs to know about the Concert Series:

### Who's playing?

Friday, August 2, 2019 - Featuring **David Wilcox** with **Honeymoon Suite**, and **Revive the Rose**, presented by **91.7 Giant FM**. Gates open at 6 p.m. Show starts at 7 p.m. and finishes at 11 p.m.

Saturday, August 3, 2019 - Featuring **I Mother Earth** with **Finger Eleven** and **Drop Top Alibi**, **97.7 HTZ-FM Rock Search Winners**, presented by **97.7 HTZ-FM**. Gates open at 6 p.m. Show starts at 7 p.m. and finishes at 11 p.m.

Sunday, August 4, 2019 – Featuring **Doc Walker**, **Madeline Merlo** and **Brad Battle**, presented by **Country 89.1** and funded by **Celebrate Ontario**. Gates open at 6 p.m. Show starts at 6:30 p.m. and finishes at 10 p.m. in time for the fireworks display.

Monday, August 5, 2019 - Featuring the **Caverners**, Canada's Premier Tribute to the Beatles with **Tim E. Hendry**, the 2013 King of the World Elvis Tribute Artist World Champion, presented by **610 CKTB & 105.7 EZ ROCK**. Gates open at 11 a.m. Show starts at 12 p.m. and finishes at 4 p.m.

### Some important Concert Series facts:

- Specific times for the artists to play are not released. Once the festival grounds reaches capacity the gates are closed.
- Our Concert Series is FREE, however, we ask attendees to pay what they can be way of donation at the gates. While waiting in line at one of our three entry points be entertained by our Real Pyrates, funded by Celebrate Ontario, who will be coming around for photo opportunities!
- All concerts are open to all ages in a licensed OPEN-AIR concept venue. Those wishing to enjoy alcoholic beverages will be required to show proper identification and obtain a wristband at the entrances to purchase tickets for Molson Coors and cooler products. Those 19+ will be wrist banded.
- Bag checks will take place at all entrances. Note: there are three entrances.
- No outside beverages are allowed in the concert area.
- Lawn chairs are permitted in designated areas.
- There is NO smoking or vaping permitted in the concert area.
- Food Vendors on site include: Country Boys, Daddy Hacks Snackery, Johnny Rocco's Pizza Oven, and Alfie's Lemondae

# Media Release

- There are two ATM machines available at H.H. Knoll Lakeview Park and the alcohol ticket tent will have Point of Sale (POS) machines.

## Concert Map:

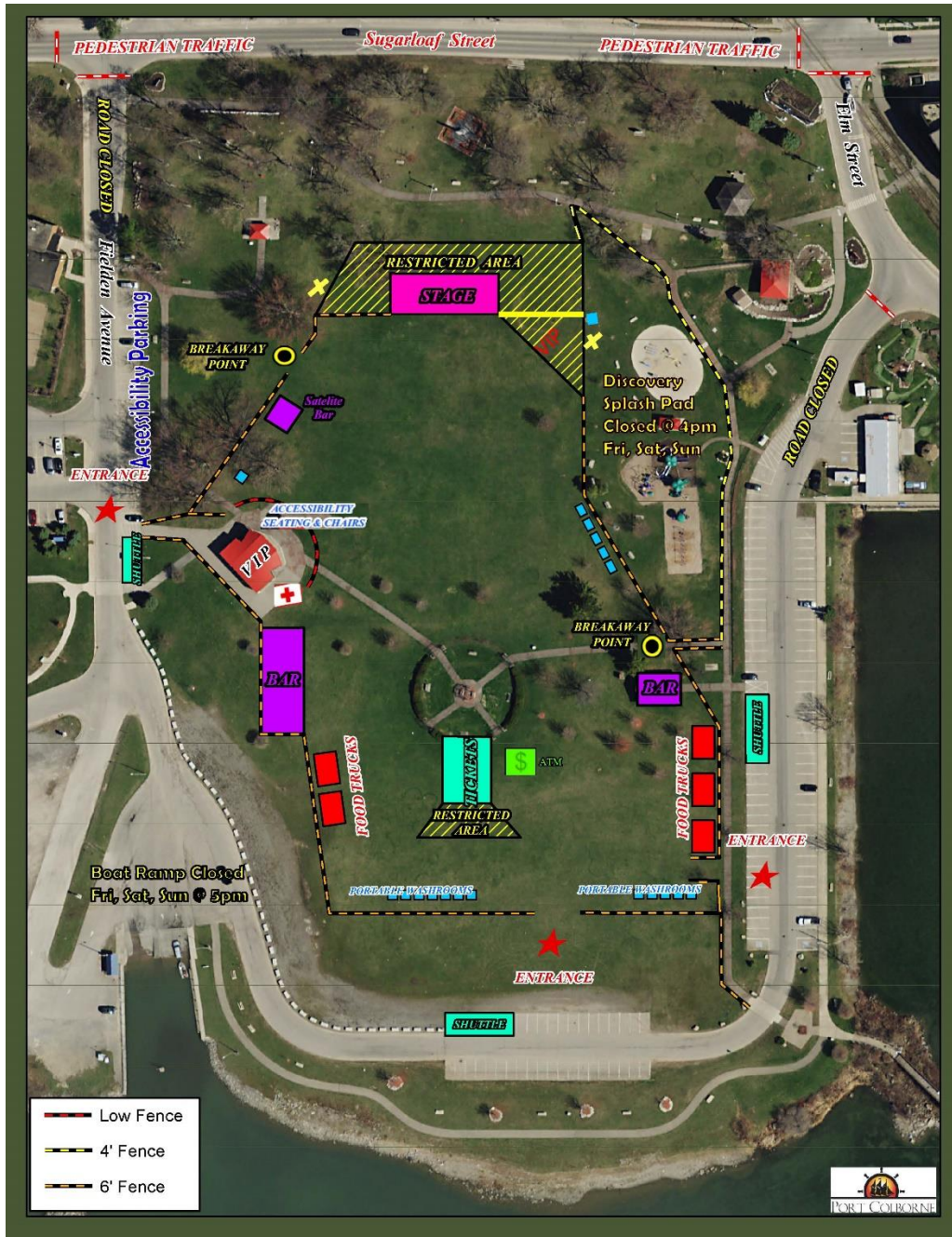



## Media Release

### Travelling to the Concert Series?

**NEW for 2019: Take the Go Train Connect.** This service is offered Saturday, August 3 and Sunday, August 4 only. The shuttle will drop off and pick up at the West Side Park and Ride location at the West Side Plaza, 53 West Side Road.

The GO arrives in St. Catharines GO Train Station, 5 Great Western Street L2S 2K3 at 10:38 a.m. and 5:56 p.m. The FREE shuttle bus, operated by Niagara Region Transit, will leave from the St. Catharines GO to Port Colborne at 10:45 a.m. and 6:05 p.m.

The shuttle bus departs Port Colborne from the West Side Park and Ride to the St. Catharines GO at 7 p.m. and 10:40 p.m. The GO train leaves St. Catharines GO at 7:45 p.m. and 11:25 p.m.

For more information, visit: <https://www.niagararegion.ca/transit/canal-days.aspx>

### Road Closures:

The following roads will be closed beginning at 2 p.m. to 12 a.m. on Friday, August 2, 2019, Saturday, August 3, 2019, and Sunday, August 4, 2019 for the purpose of hosting the Canal Days Concert Series:

- Steele Street, from the southern limit of Steele Street at Sugarloaf Street;
- Steele Street, from the eastern limit at Steele Street at Sugarloaf Street;
- Isabel Street, from the southern limit of Isabel Street at Sugarloaf Street;
- Fielden Avenue, from the northern limit of Fielden Avenue at Sugarloaf Street;
- Fielden Avenue, from the southern limit at Sugarloaf Street;
- Lighthouse Lane, from the southern limit at Sugarloaf Street;
- Elm Street, from the southern limit of Elm Street at Sugarloaf;
- Elm Street, from the western limit of Elm Street at Sugarloaf Street;
- H.H. Knoll Lakeview Park parking lot, south of Dawg's Burgers and Fries to Fielden Avenue.

### Parking Provisions:

The following areas will be closed/restricted to street parking beginning at 4 a.m. on Friday, August 2, 2019 and ending at 6 p.m. on Monday, August 5, 2019:

- Northside of Kent Street between the western limit of Catharine Street and the eastern limit of Elm Street.
- The thirteen (13) parking spaces on the west side of King Street from Sugarloaf Street to Charlotte Street;
- The two (2) parking spaces on both east and west sides of King Street, north of the Charlotte Street limit, be closed to parking to allow for the shuttle bus stops,

Beginning Friday, August 2, 2019 at 6 a.m. through until Monday, August 5, 2019 at 5 p.m. the following parking provisions are in place. Any vehicles (including trailers, RV's, etc.) will be ticketed and towed at



## Media Release

owner's risk and expense. Any vehicles parking within 3m of a Fire Hydrant will be ticketed and towed immediately.

LOCATION	SIDE OF ROADWAY	FROM
Elm Street	East	Sugarloaf to Clarence Street
Fielden Avenue	East	Sugarloaf to Clarence Street
Steele Street	East	Sugarloaf to Clarence Street
Breakwater Laneway	Both	Entire length
Lockmaster Laneway	Both	Entire length
Lighthouse Laneway	Both	Entire length
Foghorn Laneway	Both	Entire length
Schooner Laneway	Both	Entire length
Harbour Laneway	Both	Entire length
Isabel Street	Both	Entire length

**Note:** Signage for road closures and parking restrictions will be posted prior to closures; however, enforcement will not occur unless violation occurs within the posted day/time.

### Accessible Parking for the Concert Series:

Accessible parking is available on the West Side of H.H. Knoll Lakeview Park. Access via Fielden Avenue and present your accessible parking decal.

Accessible seating is also available in front of the existing Bandshell.

See map for details.

### Festival Shuttle Services:

<b>Friday August 2, 2019</b>	<b>4 p.m.- 12:30 a.m.</b>	<b>Friday August 2, 2019</b>	<b>4 p.m. - 12:30 a.m.</b>
<b>EAST SIDE SHUTTLE</b>		<b>WEST SIDE SHUTTLE</b>	
(Vale Health & Wellness Centre, 550 Elizabeth Street)		(West Side Plaza Parking Lot, 53 West Side Road)	
Vale Health & Wellness Centre- YMCA		King St/Elgin (Museum, Carnival, Food & Kids Zone)	



## Media Release

<p>Welland Avenue (Kids Zone, Vendors &amp; Food)</p>	<p>King St/Clarence St (Vendors, Food, City Hall &amp; Vessels, main festival)</p> <p>Sugarloaf St/Elm (CONCERTS, Marina &amp; Lighthouse Tours)</p>
<p><b>Saturday, August 3, 2019</b>      <b>10 a.m.-12:30 a.m.</b></p>	<p><b>Saturday, August 3, 2019</b>      <b>10 a.m. - 12:30 a.m.</b></p>
<p>Welland Avenue (Kids Zone, Show, Vendors &amp; Food)</p> <p>Vale Health &amp; Wellness Centre - Craft Show, YMCA</p>	<p>King St/Elgin (Museum, Carnival, Food &amp; Kids Zone)</p> <p>King St/Clarence (Vendors, Food, Patio on West, City Hall &amp; Vessels, main festival)</p> <p>Killaly St/Westside Rd (Kite Show until 10 p.m.)</p> <p>Sugarloaf St/Elm (CONCERTS, Marina &amp; Lighthouse Tours)</p>
<p><b>Sunday, August 4, 2019</b>      <b>10 a.m.-12:30 a.m.</b></p>	<p><b>Sunday, August 4, 2019</b>      <b>10 a.m.-12:30 a.m.</b></p>
<p>Welland Avenue (Kids Zone, Vendors &amp; Food)</p> <p>Vale Health &amp; Wellness Centre - Craft Show, YMCA, Car Show</p>	<p>King St/Elgin (Museum, Carnival, Food &amp; Kids Zone)</p> <p>King St/Clarence (Vendors, Food, Patio on West, City Hall &amp; Vessels, main festival)</p> <p>Killaly St/Westside Rd (Kite Show until 6 p.m.)</p> <p>Sugarloaf St/Elm (CONCERTS, Marina &amp; Lighthouse Tours)</p>



## Media Release

Monday, August 5, 2019	10 a.m.- 4:30 p.m.	Monday, August 5, 2019	10 a.m.- 4:30 p.m.
Vale Health & Wellness Centre-YMCA Welland Avenue (Kids Zone, Vendors & Food)		King St/Elgin (Museum, Carnival, Food & Kids Zone) King St/Clarence St (Vendors, Food, Concerts, City Hall & Vessels) Sugarloaf St/Elm (CONCERTS, Marina & Lighthouse Tours)	

### Facility Closures:

#### **Playground & Discovery Spray Pad at H.H. Knoll Lakeview Park:**

Will close at 4 p.m. Friday August 2, Saturday, August 3, and Sunday, August 4, 2019.

#### **Sugarloaf Marina Boat Launch Ramp:**

Will close at 5 p.m. Friday August 2, Saturday, August 3, and Sunday, August 4, 2019.

Inquiries regarding parking provisions during the festival? Call 905-835-2900 ext. 207 or email [bylawenforcement@portcolborne.ca](mailto:bylawenforcement@portcolborne.ca).

Parking is FREE at the festival, however, Canal Days is not responsible for lost, damage, tickets or towing to vehicles. All vehicles are to comply with rules & regulations under the Parking & Traffic Bylaw # 89-2000.

Canal Days Marine Heritage Festival reminds visitors to leave their pets at home. Festival grounds only allow for service animals.

To stay up to date with information about the 41<sup>st</sup> Annual Canal Days Marine Heritage Festival, visit [www.canaldays.ca](http://www.canaldays.ca), like on Facebook (@CanalDays), or follow on Twitter & Instagram (@canaldayspc).

### **Canal Days sponsors include:**

**Title** – Rankin Construction Inc. and Vale

**Quartermasters** – Pinty’s Delicious Foods, and The St. Lawrence Seaway Management Corporation.

**First Mates** – Algoma Central Corporation, Scotiabank, Canada Steamship Lines, Tim Hortons, CapServCo/Grant Thornton, Molson-Coors, Lower Lakes Towing Ltd, Battlefield Equipment Rentals, and McAvoy, Belan & Campbell / Frank Cowan Company.



## Media Release

**Boatswains** – Brandon’s No Frills, Brock University, Canadian Niagara Power / Fortis ON, Enbridge, Sid Grabell Contracting, Sewell’s NAPA Auto Parts, and Sullivan Mahoney LLP.

**Deckhands** - Hamilton Port Authority, Chamber of Marine Commerce, Port Colborne Marine Terminal, Aquicon Construction, B&C Truck and Auto Industrial, Bosch Rexroth, Canadian Tire, CIBC, Circle P Paving, David Chev, Pizza Hut, King Contractors of Niagara, Barber Hymac, Stolk Construction, Subway, Ultramar, Shisler Bros. Landscaping Material, Harvey’s Swiss Chalet, and Port Colborne Grain Terminal a division of Parish and Hiembecker Limited.

**Media Partners** – 610 CKTB, 105.7 EZ Rock, 97.7 HTZ-FM, 91.7 Giant FM, Country 89.1, CHCH, YourTV Niagara, Niagara this Week, and Niagara Dailies.

-30-

**For more information, contact:**

Michelle Cuthbert  
Corporate Communications Officer, City of Port Colborne  
905-835-2900 ext. 307  
michellecuthbert@portcolborne.ca